

# ORWAK 5070

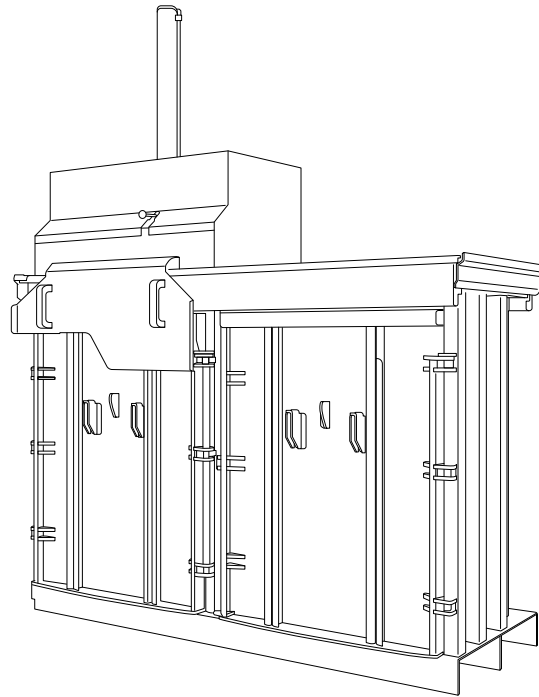

## ORIGINAL OPERATING INSTRUCTIONS



CONTENTS

Safety information..... 4

Parts of the machine..... 5

Safety..... 6

Operating instruction.... 7

Technical specification.. 8

Dimensional drawing.... 8

Transport..... 8

CE..... 9

Installation..... 10

Weekly inspection and maintenance..... 11

Hydraulic diagram

Electrical diagram

IDENTIFICATION



Svetsaregatan 4

576 33 Sävsjö

Sweden



Type \*

Product No \* \* \*

Serial No \* \*

Date

Weight

V ~ Hz

kW

A

+40 °C

+5 °C

-10 °C \*\*





- \* - XXXX (ex Compactor 5070)
- \*\* - XXXxXX (ex 121001)
- \*\*\* - 490XXXX - XX (ex 4905070-00)

You find the serial number on the baler.

For any inquiries, please indicate the type and serial number of the baler.

### OPERATOR WARNING & DUTY

This manual must be available permanently near the baler. Each operator must read and follow the full instruction of this manual before being authorize.

All operator must absolutely study and fully understand the operator's manual, specifically pay a particular attention to the safety procedure section.

In case of misunderstanding or doubt, do not start the machine. Contact support service.

Operators and service staff must comply by wearing personal protective equipment (PPE) before using or performing any maintenance operation following rule and regulation code.



Operator and service personal must be trained during the commissioning on the baler operation, by a duly authorized person from the manufacturer.

To avoid any mistake or accident, all operators must understand the operator manual.



All operators must absolutely study and fully understand the operator's manual.  
This manual must remain available for any personal involve with the baler.

### SAFETY SIGN - In the manual



Warning !

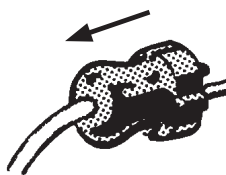

Disconnect the power to the machine by removing the plug from the wall socket.

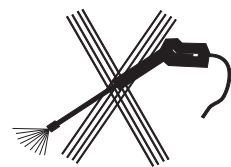

Do not flush water on the baler.

## PARTS OF THE MACHINE

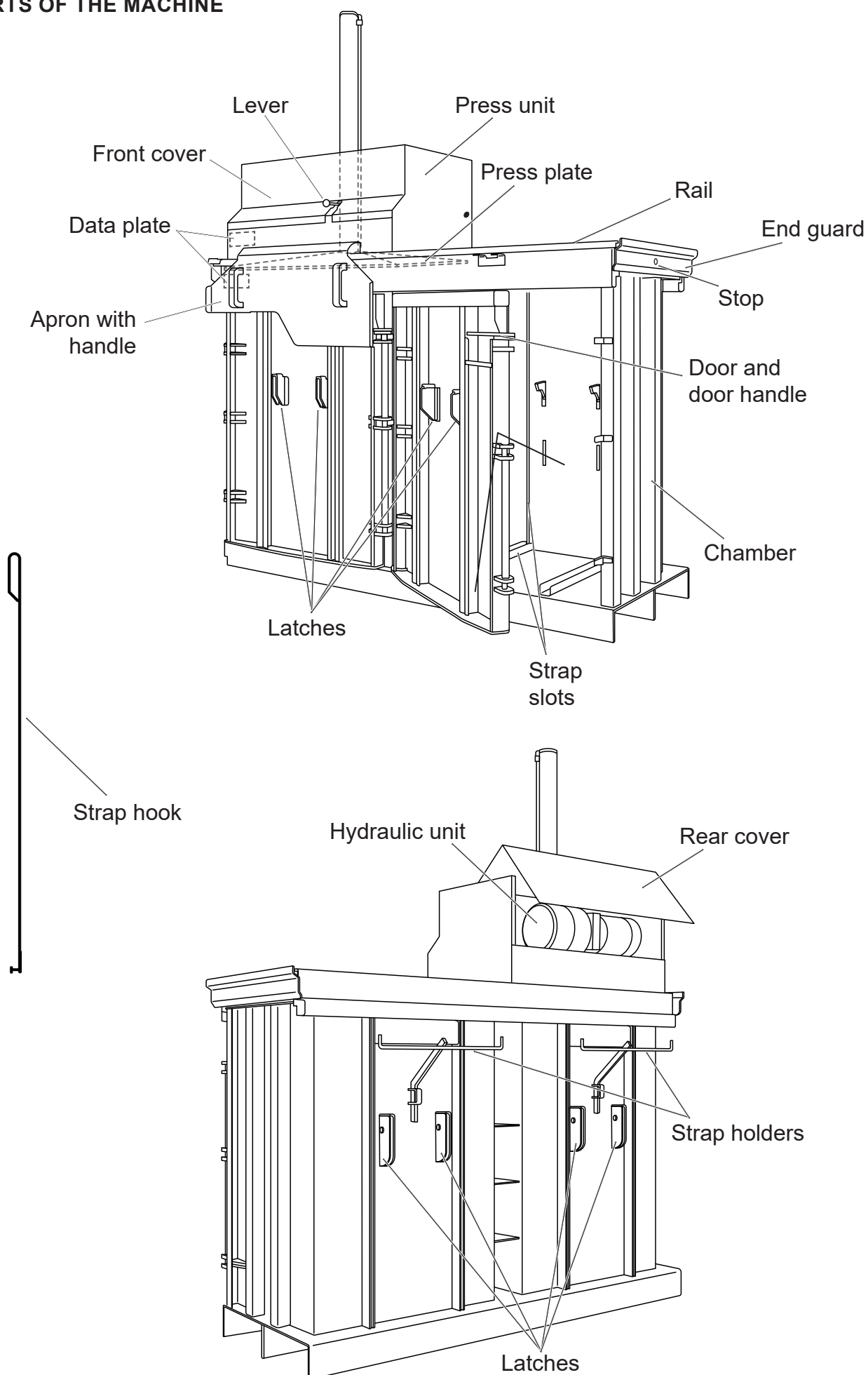

## IMPORTANT SAFETY INSTRUCTIONS

Please read the operating instructions **BEFORE** operating the machine and then **SAVE THE INSTRUCTIONS**.

Our warranty/product responsibility requires that:

- instructions are followed, and that no conversion or modification is carried out.
- original spare parts, and hydraulic oils and lubricants recommended by the machine manufacturer are used.
- at least one annual service is carried out.

*The user of the machine is responsible for the safety checks, and for ensuring that daily maintenance of the machine is carried out.*

*The user is responsible for seeing to it that defects are rectified, and that neither the user or other persons are subjected to danger.*

*The owner is responsible for ensuring that all laws and instructions are complied with when using the machine.*



This symbol means WARNING or DANGER - personal safety instruction!



This machine is designed for ONE MAN OPERATION.  
Only the operator is allowed in the machine's working area.



The machine must not be used if the safety functions (e.g. switches and protections) have been deactivated, damaged or removed. Do not operate the machine if the cord or plug is damaged. Lost or damaged parts must be replaced with original spare parts.



The machine has a high centre of gravity. If the machine needs to be moved, the press plate must be lowered fully before moving.



Installation and service work may only be performed by qualified and competent staff, and in accordance with the installation and service instructions.



The machine must not be used in a public environment but is intended for use in warehouses or the like.



The machine **must not** be used by minors.



**Never** climb on the machine.



Use both hands when pushing the press unit over to the next chamber and do not fill higher than 100 mm from the top of the chamber.  
**DO NOT OVERFILL THE CHAMBER.**



The machine may only be operated by a person who has received training and has experience of the machine. Do not touch moving parts.



The machine must be placed on a stable and flat surface capable of permanently supporting the machine (reinforced concrete slab or equivalent).  
**REMARK!** If the surface is not level, anchor the machine to the ground!

## SAFETY FEATURES

The machine is equipped with the following safety features:

Mechanical and electrical switches that prevent the machine from being used when the compactor head is being moved, the front cover is opened, mechanical interlocking of doors and cover plates that protect the operator from the machine's moving parts.

## RANGE OF APPLICATION

The machine is a hydraulically operated baler intended for compacting bulky materials such as cardboard, paper and plastic. The material being compacted must be evenly distributed in the chamber. The machine may only be used in areas that have a roof, protection against wind and normal lighting. The machine is intended for use within the temperature range -10°C to +40°C.

A low-temperature oil and/or heater should be used at temperatures lower than +5°C.

The machine must be used indoors in premises with normal lightning.

The machine is equipped with a key switch, this can limit the use if wanted.



Risk of electric shock if the machine is stored outside and exposed to rain.



Materials that are flammable or of an explosive nature, such as pressurised containers or equivalent which, when exposed to pressure or sparks, could cause damage, fire or an explosion, must not be compacted in the machine.



Use only straps recommended by the machine manufacturer.



**NOTE!** If this machine is supplemented with containers (400 L or 660 L) the entire supplementary operating instructions for CONTAINERS must be read through prior to use.

# OPERATING INSTRUCTIONS



## WARNING!

Only the operator is allowed in the machine's working area!



## Mounting the strap

- 1 Pull the compactor unit to one side.
- 2 Pull the strap through the slot on the rear of the container.
- 3 Thread the strap through the slot in the door and secure the strap with a loop on the front.
- 4 Use the bale tool and position the strap in the slot at the bottom and rear of the container.

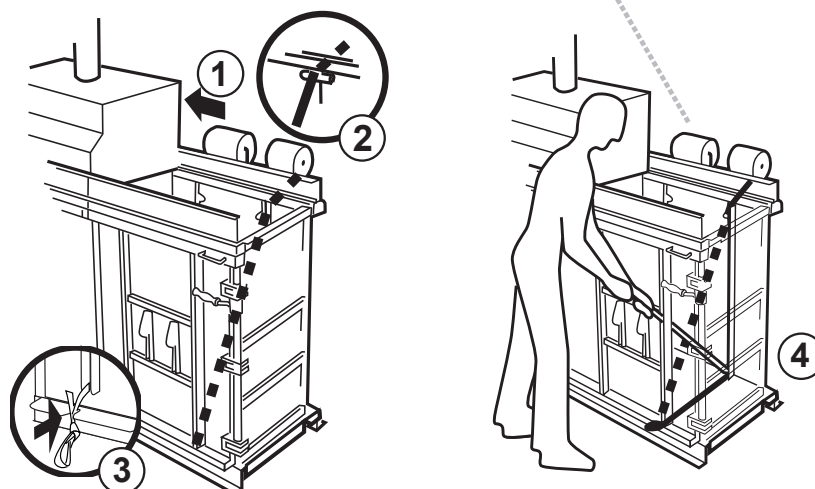

## Compaction

- 5 Place the waste evenly distributed in the chamber.
- 6 Pull the compaction unit over the waste.
- 7 Press the lever for an automatic press cycle.

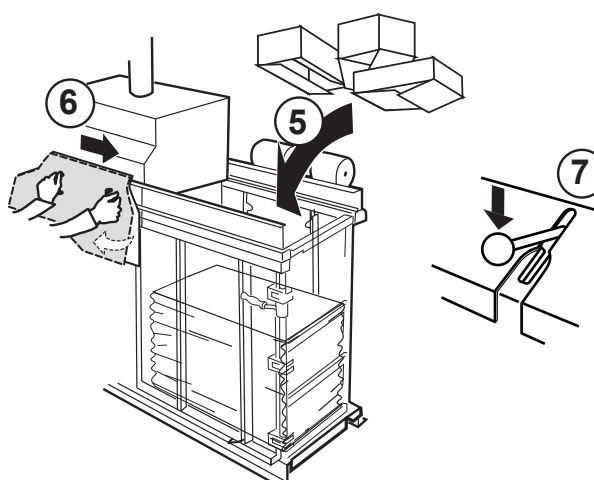

## Baling

- 8 Pull the strap through the slot from the rear of the chamber.
- 9 Pull the strap over the waste and through the slot at the front of the chamber.
- 10 Cut the strap with the knife.
- 11 Press down the lever.
- 12 Wait until the press plate is just about to turn.
- 13 Turn the bale switch to 0 just as the press plate is about to turn upwards.
- 14 Tie the straps.
- 15 Pull the compactor unit to one side.
- 16 Open the door.
- 17 Remove the bale.

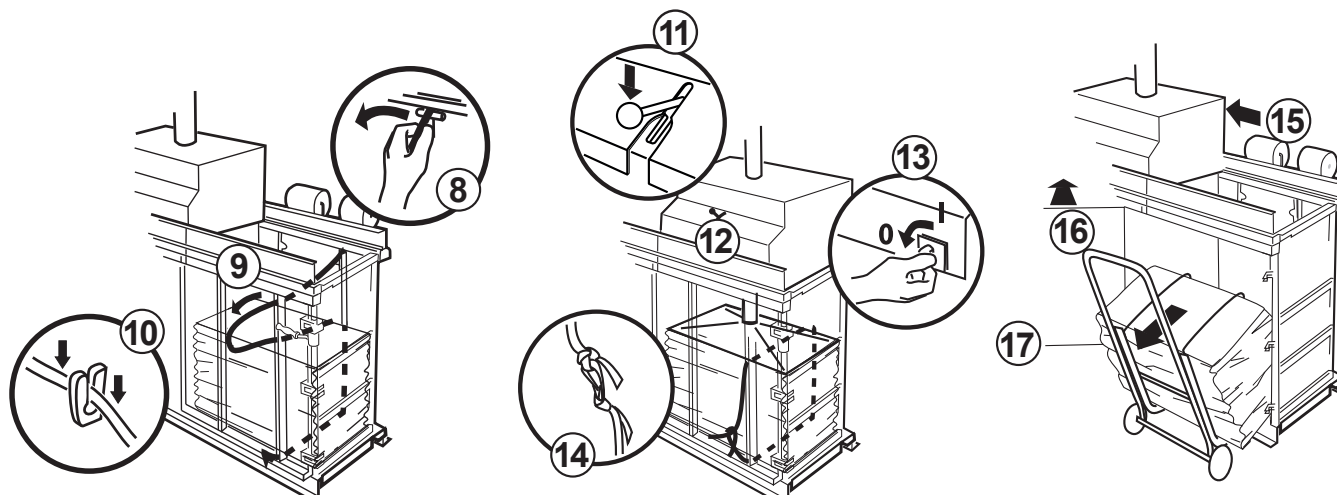

# English

## TECHNICAL SPECIFICATIONS

(Valid for 490 5070-00 unless otherwise indicated)

### GENERAL DATA

Double container: 365 kg (833 lbs)  
Compactor unit: 157 kg (352 lbs)  
Total weight: 522 kg (1,185 lbs)

#### Dimensions:

Height: 2160 mm (7'1")  
Width: 1740 mm (69")  
Depth: 880\* mm (35")  
Transport height: 2160 mm (7'1")  
\*including strap holders

Recommended floor space for a machine in operation:

Height: 2160 mm (7'1")  
Width: 2940 mm (116")  
Depth (open door): 2030 mm (80")

#### Container dimensions:

Height: 960 mm (38")  
Width: 700 mm (28")  
Depth: 500 mm (20")

#### Bale size:

Height: 700 mm (28")  
Width: 700 mm (80")  
Depth: 500 mm (20")

Weight (paper): up to 50 kg

Weight (plastic): up to 80 kg

Noise level: 70 (± 1.0) dB (A)  
(ISO 11200 & 11202)

Paint: Two-part paint and powder coat with phosphatising as base.

### ELECTRICAL DATA

Operating power: 230 V, 50/60 Hz  
Electric motor: 1.1 kW

Electrical connection: 10 A  
Protection class: IP 55

### HYDRAULIC DATA

Working pressure: 110 bar (1595 psi)

Relief pressure: 140 bar (2030 psi)

Compacting force: 3 t (30 kN) (6,600 lbs)

Surface pressure: 0.9 kg/cm<sup>2</sup> (12.8 psi)

Cycle time total: 36 s.  
Piston stroke: 790 mm (31")  
Oil volume, tank: 4.9 L (1.3 gal.)  
Max. temperature: 70 °C (158 °F)

#### Recommended hydraulic oil:

**+5°C to +60°C:**

ISO VG 32-68, Mineral oil

#### below 5°C:

A special oil or a heater may be needed at lower temperatures.

A=2160  
B=735  
C=1740  
D=1205  
E=656  
F=138  
G=1660  
H=1430

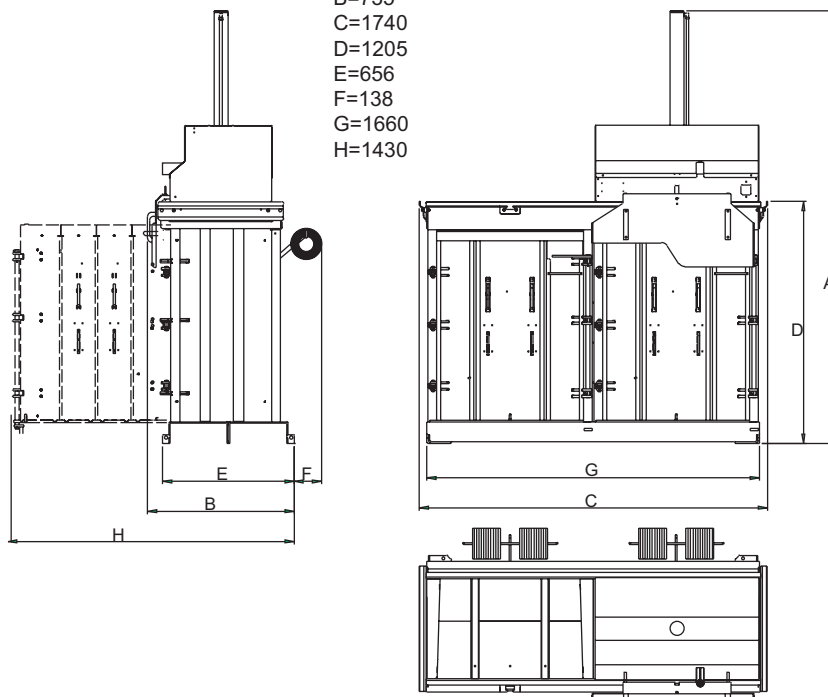

### 5070, 5070 HDC

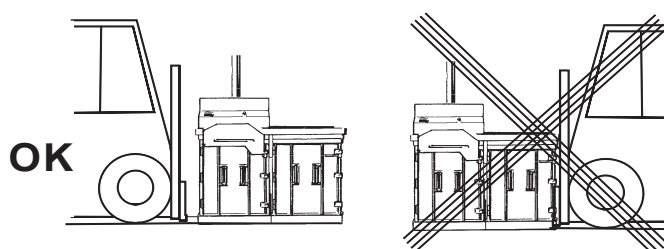
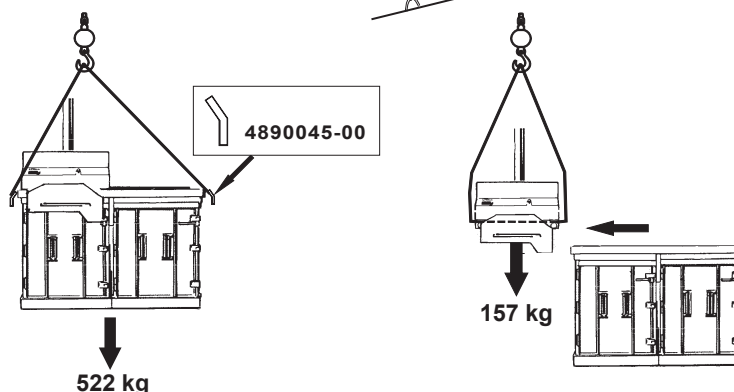
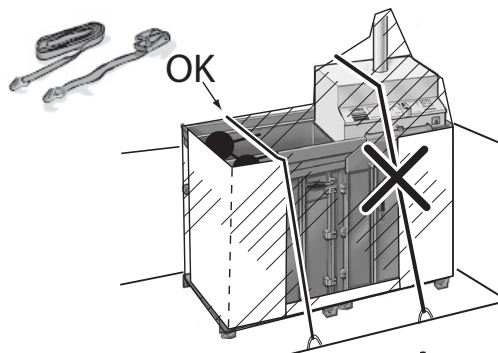



## EC DECLARATION OF CONFORMITY



We Orwak AB  
Svetsaregatan 4  
S-576 33 Sävsjö, Sweden  
Tel: 46-382-15700

declares under its sole responsibility that the product model

**4905070-00 - 4905070-99**  
**4905070-S001 - 4905070-S999**

to which this declaration relates is in conformity with the following standards or other normative documents following the provisions of Directive

2006/42/EEC (Machinery Directive)  
2014/30/EU (EMC Directive)  
2011/65/EU (RoHS II)

The machine fulfils the requirements of PL =  
c and category 1 according to EN ISO 13849-1

EN 60204-1	(Safety of Machinery – Electrical Equipment of Machines)
EN 61000-6-1	(EMC Immunity for residential, commercial and light-industrial environments)
EN 61000-6-2	(EMC Immunity for industrial environments)
EN 61000-6-3	(EMC Emission standard for residential, commercial and light-industrial environments)
EN 61000-6-4	(EMC Emission standard for industrial environments)
EN ISO 13849-1	(Safety of Machinery – Safety-related parts of control systems)

Sävsjö 2023-02-28

A handwritten signature in blue ink, appearing to read "Philip Karlsson", with a long horizontal stroke extending to the right.

Philip Karlsson

Compiler of technical documentation

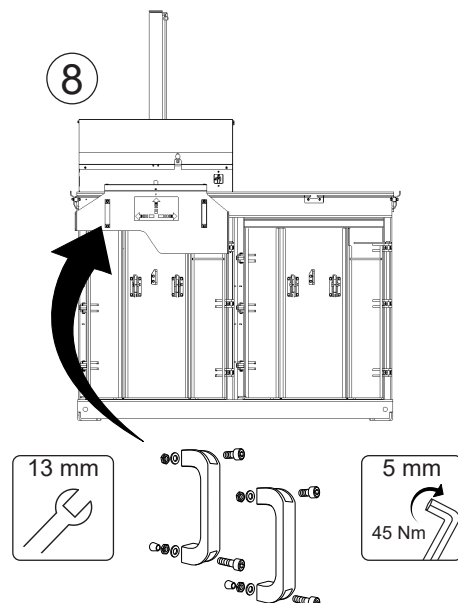
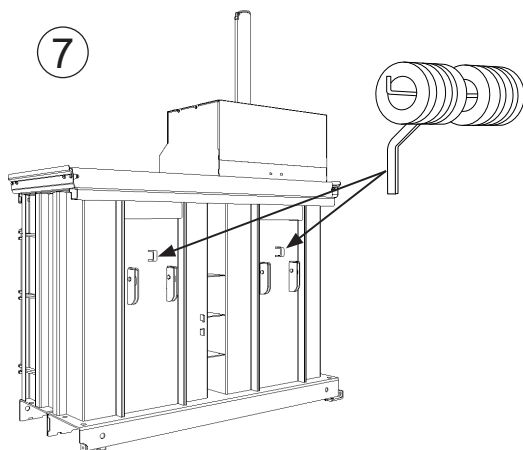
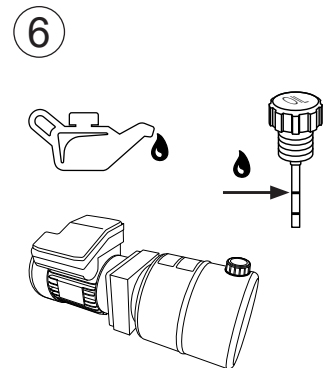
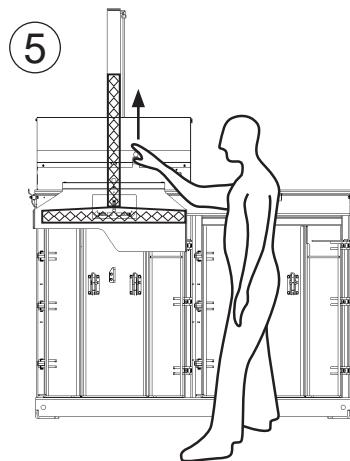
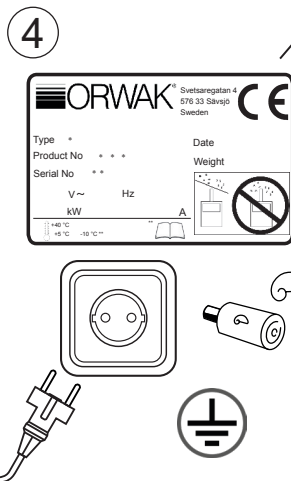
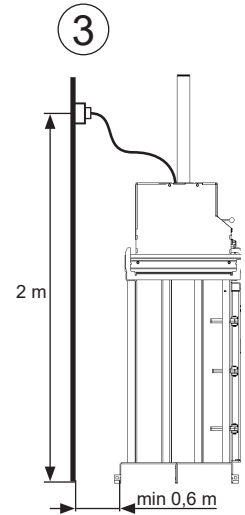
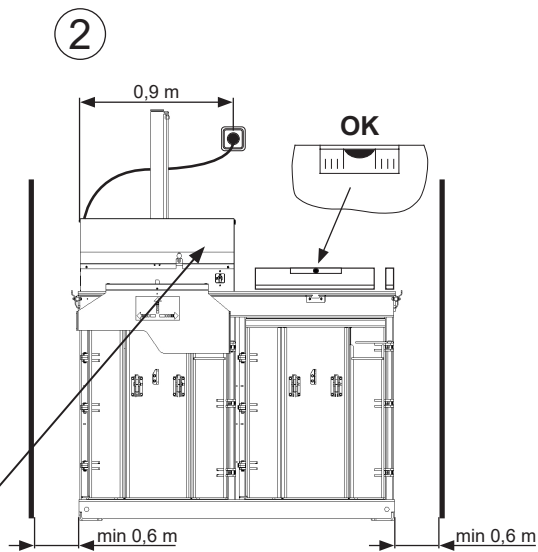
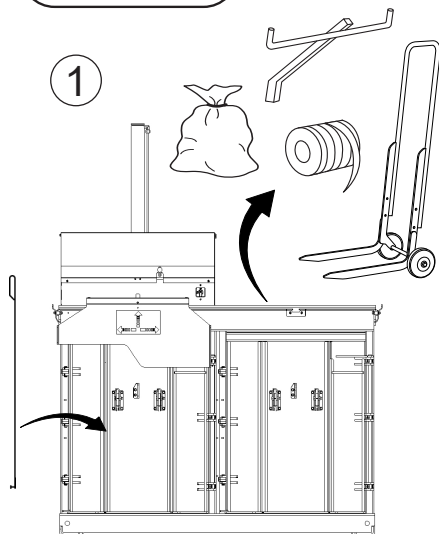
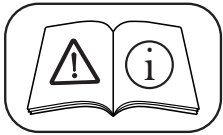

## WEEKLY INSPECTION AND MAINTENANCE



NOTE! During inspection and maintenance, service work and the removal of trapped waste, etc.:

1. Disconnect the current to the machine.
2. Do not work inside the machine

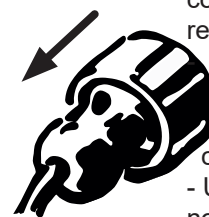

- To disconnect, turn all controls to "off", then remove plug from outlet.
- Do not unplug by pulling on the cord. To unplug, grasp the plug, not the cord.
- Unplug from outlet when not in use and before servicing or cleaning.

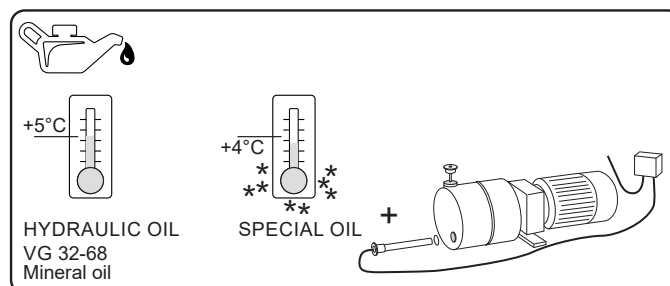
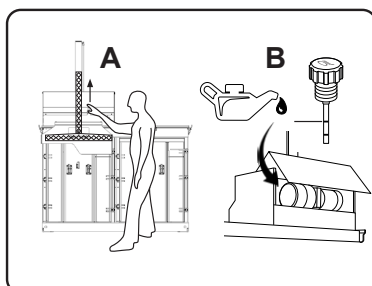
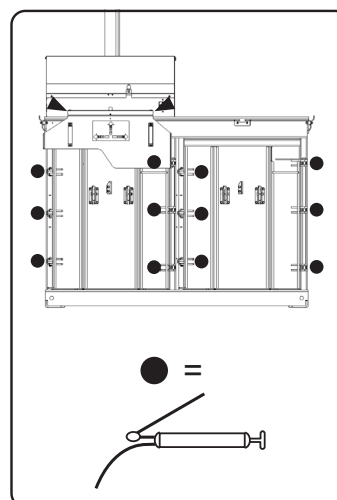
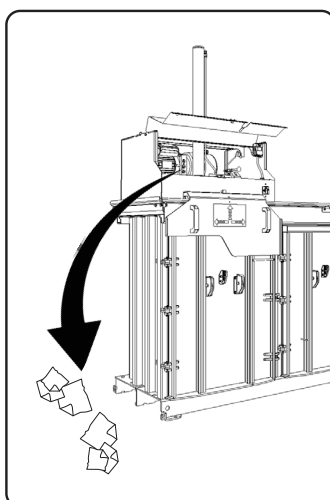
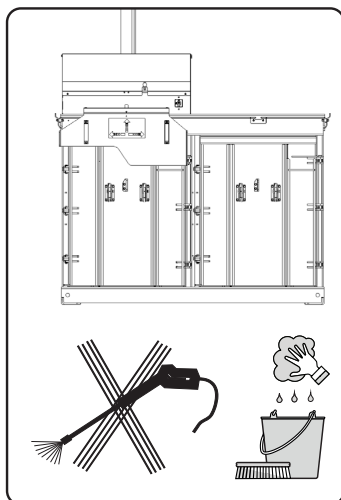

## TROUBLESHOOTING: FIRSTLY, CHECK

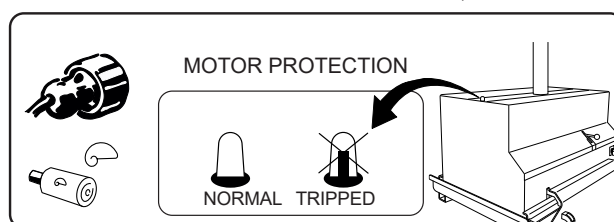

## SAFETY CHECK

- Check annually the limit switch and the piston activated by the switch in accordance with the service instructions. NOTE! In extremely dusty environments, this check should be performed quarterly. Contact authorised service personnel immediately if the press plate can be started in any position other than directly above the container, or with the front door open.

- Check that all covers and guards are intact.
- Check that there are no oil leaks on the machine.
- Check that the electrical supply cable is intact and properly protected against impact.

If any faults are discovered in the functions listed above, the machine must not be used until it has been repaired by authorised service personnel.



*Service and repairs are only to be performed by qualified and competent staff, and in accordance with the machine manufacturer's instructions.*



**Oil change:** Contact the local authorities for advice regarding how to reduce the environmental impact when dealing with residual oil.

# HYDRAULIC DIAGRAM

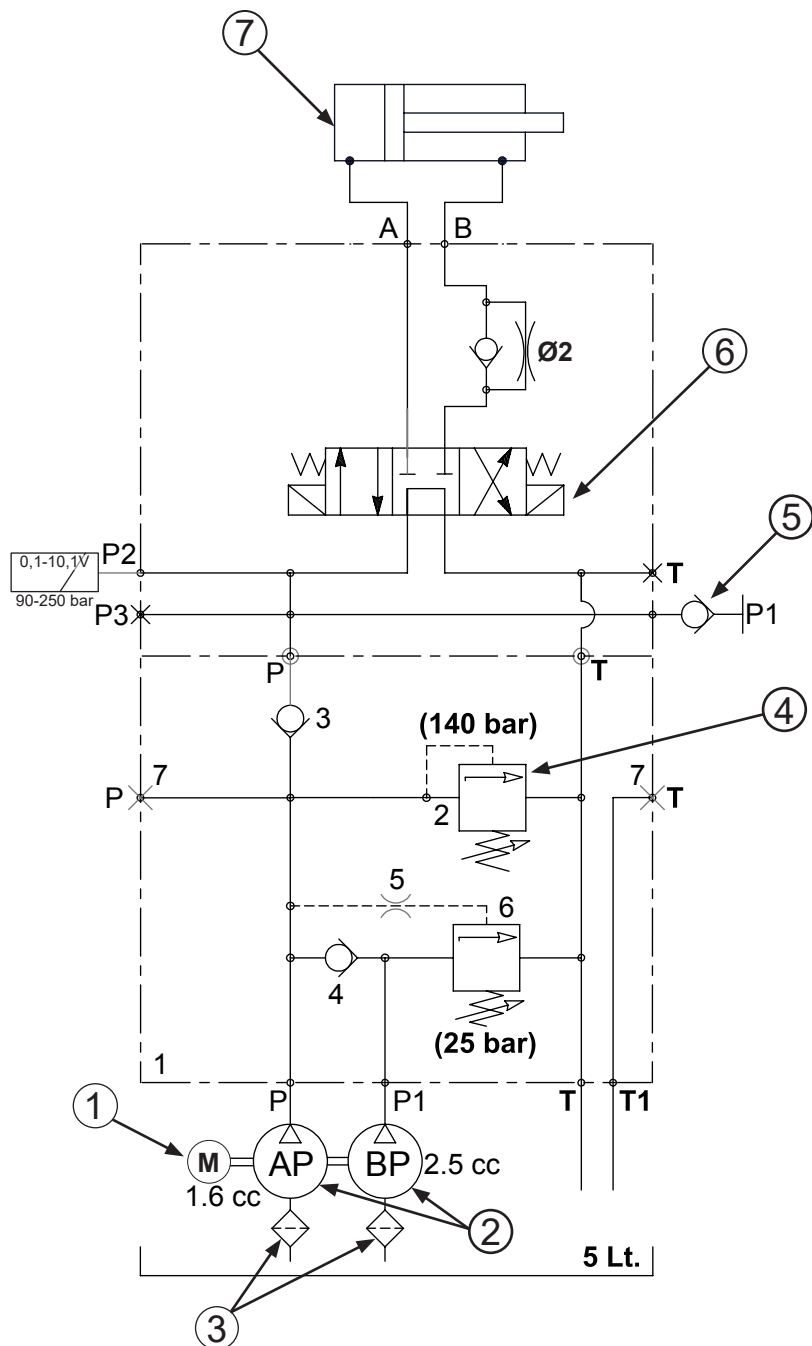

Item no.	Description Svenska	English	Deutsch	Français	Español
1	Elmotor	Electrical motor	Elektrischer Motor	Moteur électrique	Motor eléctrico
2	Dubbelpump	Double pump	Doppelpumpe	Double pompe	Doble bomba
3	Sugfilter	Suction filter	Saugsieb	Filtre	Filtro
4	Överströmsventil	Overload valve	Ventil	Soupape	Válvula
5	Mättnippel	Output pressure gauge	Manometeranschluss	Un raccord de mesurable	Racor
6	Riktningsventil	Directional valve	Richtungsventil	Soupape de direction	Válvula de dirección
7	Presscylinder	Press cylinder	Presszylinder	Verin de compactage	Cilindro de compactacion

## ELECTRICAL DIAGRAM

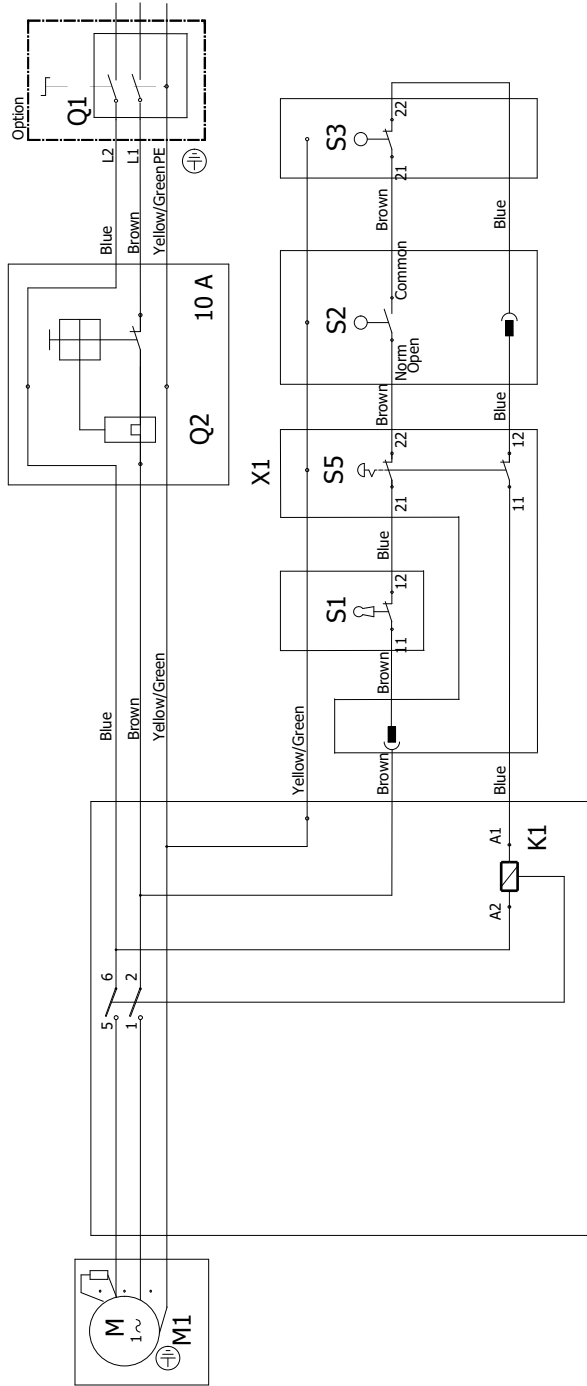

Drawing shows: Power off  
Machine at ready

ELECTRICAL COMPONENT SPECIFICATION/VERZEICHNIS DER ELEKTRISCHEN KOMPONENTENELKOMPONENTENFÖRTECKNING

Motor contactor / Motorrelais, Kontaktor / Motorkontaktor

Motor  
Motor protection device/Motor schutz/Motorskydd

Shutter switch / Klappeschalter / Luckbrytare

Limit switch / Grenzlageschalter / Gränslägesbrytare

Emergency stop/ Stop druckknopf "NOT AUS"/ Nödstopp

Schaltplan zeigt:Spannung aus Maschine bereit

Schaltplan zeigt:Spannung aus Maschine bereit

					2019-08-30	
					JohanF	
					Checked	
					Original	
Revision			Date	Name		

Description:	1x230V 50Hz, 1x115V 60Hz
Included in document:	ElIda, 5070, 4872269-00
Sheet description:	Circuit diagram

From serial number:

Elschema number:	4871839-00
------------------	------------

Sheet 4.e





# COMPACTION SOLUTIONS FOR MOST TYPES OF WASTE

---

ORWAK develops solutions for sorting and recycling waste materials that improve business efficiency, contribute to a cleaner working and natural environment to provide the best total waste handling economy.

We offer an innovative range of products that promotes sorting at source and make waste management more profitable.

ORWAK AB  
Svetsaregatan 4  
S-57622 Sävsjö  
SWEDEN  
Tel: +46-(0)382-15700  
info@orwak.com

**ORWAK.COM**

 **ORWAK**<sup>®</sup>  
PART OF **SULO** GROUP